



ONLINE FEES & PERMISSION FORMS



VISIT OUR WEBSITE

click “SD33 Pay Online”

The screenshot displays the Chilliwack Secondary School website. At the top, there is a navigation bar with links for "Links", "Contact Us", "Translate", and a search bar. Below this is a secondary navigation bar with "School Information", "Parent Information", "Student Information", and "Departments". The main content area features three event announcements: "STORM T'S'ELXWÉYÉOW" for Tuesday, February 21; an "INDIGENOUS FAMILY GATHERING" from 3:30 - 5:00pm featuring Bannock Tacos; and a "CULTURAL NIGHT" starting at 6:00pm with Grand Entry. A red arrow points to the "SD33 Pay Online" button in the footer navigation menu. The footer also includes a welcome message, the school's motto "Ad Summum Nitamur - 'We Strive for the Highest'", and contact information for the school office.

Chilliwack
SECONDARY SCHOOL

Links - Contact Us Translate Search

School Information - Parent Information - Student Information - Departments -

STORM
T'S'ELXWÉYÉOW
Tuesday, February 21
click for more information

INDIGENOUS FAMILY GATHERING
3:30 - 5:00pm
Bannock Tacos
RSVP FOR DINNER TICKETS
rs-indigenous@sd33.bc.ca

CULTURAL NIGHT
6:00pm **GRAND ENTRY**
MC: Macella Sunshine
Hot Drum: Wild River
Arena Director: Dakota James
LIGHT FOOD and TEA & COFFEE
Contact: rick_joe@sd33.bc.ca

door prizes

EVERYONE WELCOME

MINI POW WOW

Bell Schedule Cafeteria Menu Clubs SD33 Pay Online
Registration Report Absence Staff List Storm Watch

Welcome to Chilliwack Secondary School

Ad Summum Nitamur - "We Strive for the Highest"

Located in the Fraser Valley of beautiful British Columbia, we are a learning community of over 1,500 students. We are a school that offers a wide range of academic programs as well as exceptional extracurricular opportunities.

Chilliwack Secondary School Office
46363 Yale Rd, Chilliwack B.C., V2P 2P8
P: 604-795-7295 F: 604-795-7236
Email: css-officestaff@sd33.bc.ca

YOUR LOGIN STAYS THE SAME AS YOUR STUDENT TRAVELS THROUGH THE DISTRICT!

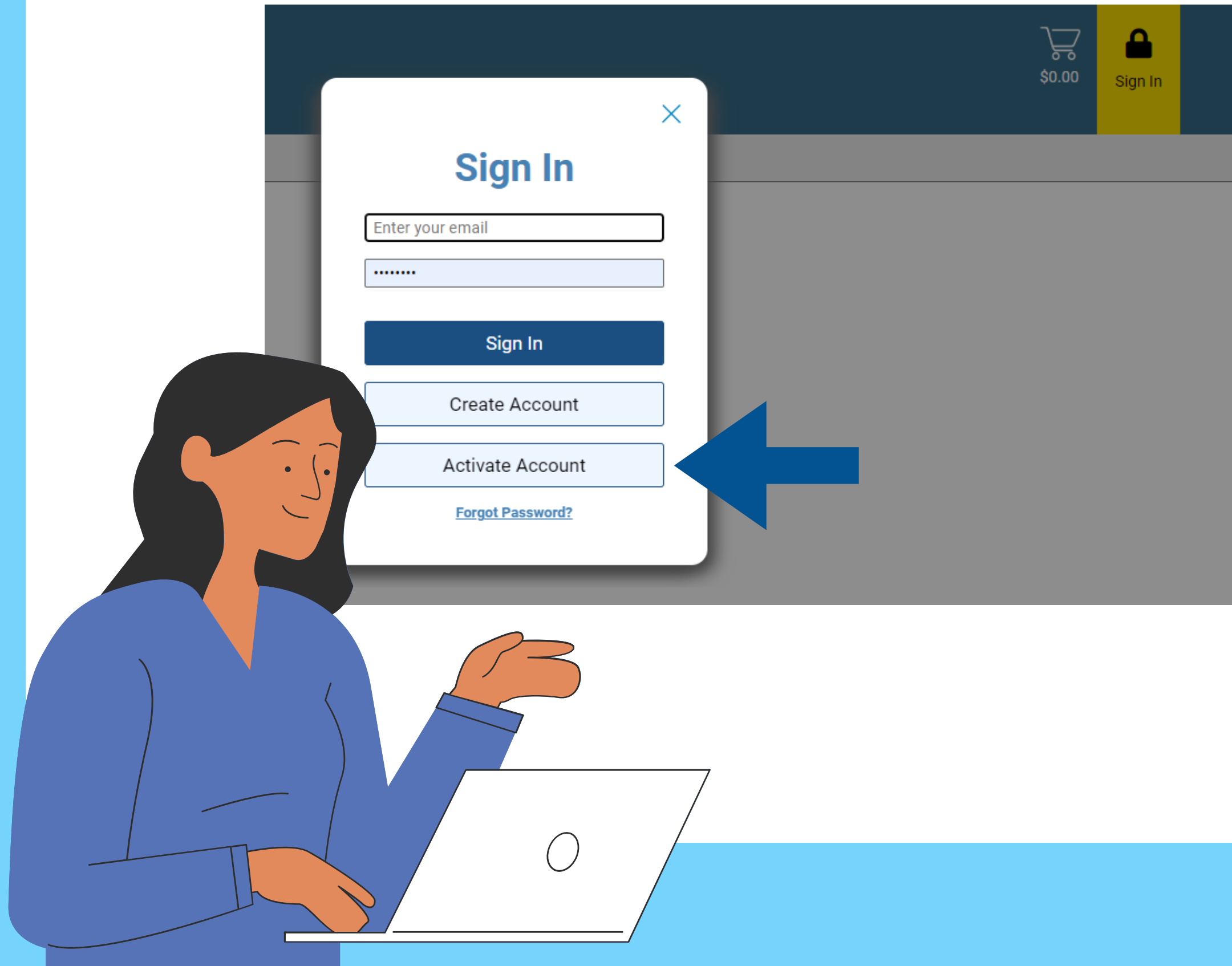

Sign in if you have used quick pay!

Activate Account if this is your first time!

Use the same email you have on file with your school

Summary Rosanne Test

 **Test Student**
00000 Grade:

CLICK STUDENTS NAME

OPTIONAL ITEMS

Athletic Permission Forms



Football Program Donation
2025/2026



Stormbucks
2025/2026



School Clothing Order
2025/2026



2025/26 Football Raffle Ticket
Draw Date: April 20th



2026 Grad Raffle Ticket

OPTIONAL ITEMS

Athletic Permission Forms





Basketball Sr. Girls Team
2025/2026



Jr. Varsity Football Team
2026/2027

ONCE IN THE CART SELECT “PARTIAL PAYMENT” TO
PAY A PORTION OF A FEE

Chilliwack
School District

Return

Total Amount
\$47.00





Payment Options

If you are unable to make a full payment at this time, you can make a partial payment.

Partial Payment

Payment Method

☒ Credit Card



☐ INTERAC® Online



Pay by Credit Card

Cardholder Name

Chilliwack Secondary School

2022/2023

Due

Pay

Fundraising

09132022 Sushi

\$10.00

\$10.00

Total:

\$10.00

\$10.00

Test Student

Chilliwack Secondary School

2022/2023

Due

Pay

Donation

2022/23 Parent Association Committee (Optional)

\$5.00

\$5.00

General

2022/23 Student Association Fee

\$20.00

\$20.00

Additional Items In Cart

Krispy Kreme Grad Fundraiser

03162023 Krispy Kreme

\$12.00

\$12.00

Total:

\$37.00

\$37.00

Due	In Cart
\$2.00	<input checked="" type="checkbox"/>
\$35.00	<input checked="" type="checkbox"/>
\$37.00	\$37.00

UNCHECK THE GREEN CHECK
BOXES TO TEMPORARILY
REMOVE ITEMS FROM YOUR
CART TO PAY AT A LATER DATE



Email:
css-finance@sd33.bc.ca
or
css-officestaff@sd33.bc.ca
with any questions!

